

Z01/...

Mat.: ≈ 1.0401/720 HV 30

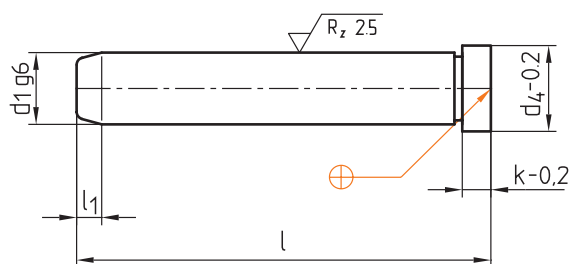

► Info



Neu / New / Nouveau

l ₁	d ₄	k	d ₁	l	Nr./No.
4	10	3	8	40	Z01/ 8x 40
				50	50
				60	60
				80	80
				100	100
4	12	3	9	40	Z01/ 9x 40
				60	60
				80	80
				100	100
				120	120
4	12	3	10	40	Z01/10x 40
				60	60
				80	80
				100	100
				120	120
7	16	6	12	40	Z01/12x 40
				60	60
				80	80
				100	100
				120	120
				140	140
7	18	8	14	60	Z01/14x 60
				80	80
				100	100
				120	120
				140	140
				160	160

l ₁	d ₄	k	d ₁	l	Nr./No.
7	18	8	15	60	Z01/15x 60
				80	80
				100	100
				120	120
				140	140
				160	160
				180	180
7	20	8	16	40	Z01/16x 40
				60	60
				80	80
				100	100
				120	120
				160	160
				180	180
7	22	8	18	60	Z01/18x 60
				80	80
				100	100
				120	120
				140	140
				160	160
				180	180
				200	200
				240	240

This is trial version
www.adultpdf.com

Z01/...

Mat.: ≈ 1.0401/720 HV 30

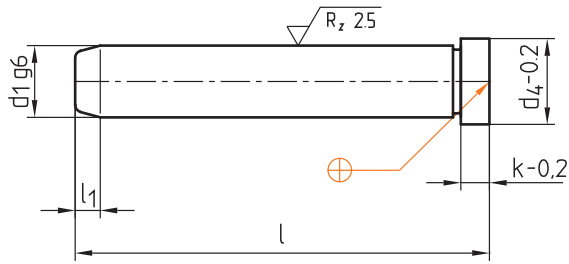

l ₁	d ₄	k	d ₁	l	Nr./No.
7	24	8	20	60	Z01/20x 60
				80	80
				100	100
				120	120
				140	140
				160	160
				180	180
				200	200
				240	240
				7	26
100	100				
120	120				
140	140				
160	160				
180	180				
200	200				
220	220				
240	240				
300	300				
7	28	15	24	80	Z01/24x 80
				100	100
				120	120
				140	140
				160	160
				180	180
				200	200
				220	220
				240	240
				300	300

l ₁	d ₄	k	d ₁	l	Nr./No.
7	36	15	30	100	Z01/30x100
				120	120
				160	160
				200	200
				240	240
				300	300
				360	360
				7	36
120	120				
160	160				
200	200				
240	240				
360	360				
10	48	15	40	160	Z01/40x160
				200	200
				240	240
				300	300
				360	360
10	58	15	50	160	Z01/50x160
				200	200
				240	240
				300	300
				360	360

This is trial version
www.adultpdf.com